

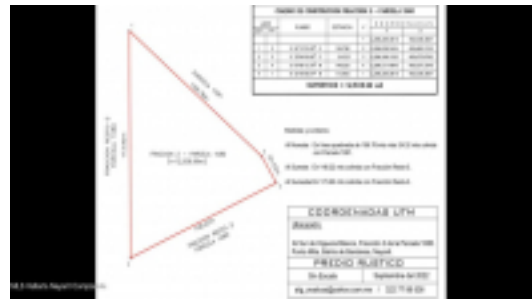

Mi S Vallarta Nayarit Compostela



Exceptional investment opportunity near Punta de Mita: 12,506.99 m² (134,624 sq ft) of lush tropical land just across from Auberge's Susurro del Corazón. Ideal for securing zoning to develop a small gated community or premium condominium regime, the property offers walkable jungle pathways, its own water source, and 4 income-producing properties (3 small cabins and one main house). A natural ridgeline provides prime sites with sweeping ocean views.

PROPERTY FEATURES

- Type: Land
- Primary View: Jungle
- Secondary View: Garden